



The Taurus-2 is a stylish leisure home offering a spacious living area with contemporary furniture and exquisite soft furnishings. The curved glass fronted, remote controlled fire, with canvas style picture above creates a stunning focal feature.

The kitchen with its soft close cupboard doors features a large integrated fridge freezer, oven and grill opposite a freestanding dining table and upholstered designer chairs.

The quality continues throughout the two and three bedroom homes with glorious soft furnishings, contemporary fitted furniture, stunning shower room and en suite toilet.



Model illustrated is the 38 x 12 – 2 bedroom with optional front French doors





INTEGRATED OVEN COMPLETE WITH GRILL AND FOUR RING HOB WITH ELECTRONIC IGNITION



LARGE CAPACITY INTEGRATED FRIDGE FREEZER AND BUILT-IN RECIRCULATING HOOD ABOVE HOB



CURVED GLASS FRONTED ELECTRIC FIRE WITH REMOTE CONTROL



CONTEMPORARY LOW LEVEL FURNITURE AND COFFEE TABLE WITH REMOVABLE SEAT TOP



FOR FULL DETAILS OF EXTERNAL DIMENSIONS FOR THIS RANGE SEE PAGES 26/27



EXTERIOR

- Plastisol coated steel pantile pitched roof
- Lagged hot and cold water exterior pipework
- Under floor insulation
- Exterior Light
- Domestic PVC guttering and downpipes

INTERIOR

- Vaulted ceilings throughout with ceiling cornice in lounge, kitchen, hall and bedrooms
- Flush woodgrain effect internal doors with satin steel domestic style door handles
- Energy efficient lighting
- Carbon Monoxide detector, smoke alarm and fire extinguisher
- Underlay fitted beneath all carpets

LOUNGE

- Scatter back style seating with fold-out sprung bed
- Contemporary low level furniture
- Curved glass fronted electric fire with remote control
- Coffee table with removable seat top
- Fully lined curtains and voiles
- Provision for flat screen TV above fire (TV and bracket not included)

KITCHEN

- Integrated 600 wide oven and grill with 4 ring hob with electric ignition
- Large capacity integrated fridge freezer
- Glass and stainless steel re-circulating hood
- Appliance shelf and socket
- Soft close cupboard doors
- 40mm high pressure bonded laminate work surfaces with matching upstands
- Venetian blind

DINING AREA

- Freestanding dining table with upholstered chairs
- Feature mirror
- Fully lined curtains
- Net curtains

BEDROOMS

- 5ft lift up double bed for extra storage
- Soft close cupboard doors
- En suite toilet
- Duvet covers and pillow cases
- Bolsters and runner for double bed

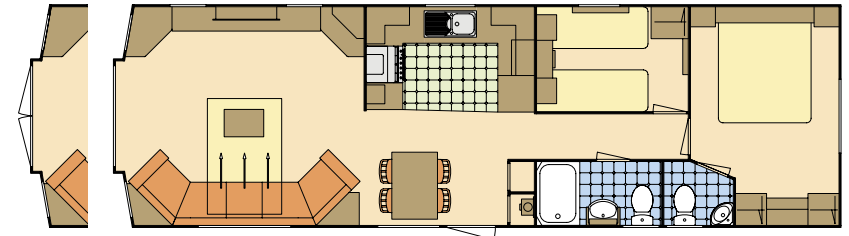

Front door option

38 x 12 - 2 bedroom 6 berth

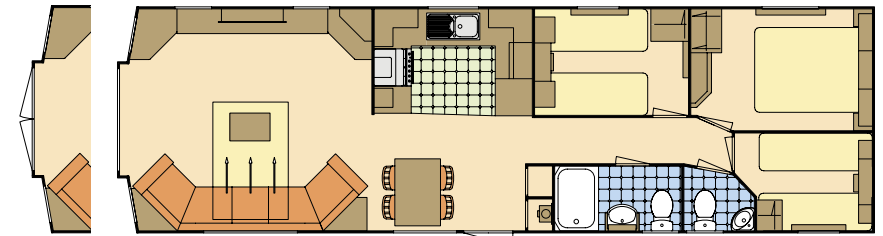

Front door option

39 x 12 - 3 bedroom 8 berth

- Twin beds combine to make a double bed if required
- Fully lined curtains and voiles
- TV point to main bedroom

BATHROOM & WC

- Close coupled toilets
- Soft close toilet seats
- Shower with seat and thermostatic mixer
- Vanity sink unit with mirror
- Wall mounted extractor fan to shower room
- Venetian blinds

OPTIONS

- Gas combi central heating with thermostatic radiator valves
- Double glazed PVCu windows and doors
- Double glazed PVCu Front French Doors
- Extra insulation
- Environmental colours
- Canexel exterior cladding
- Rigid PVC exterior cladding
- Timber cladding (will require routine maintenance)

TV, DVD player, microwave, and all other ornaments are for display only.