



The Pisces has a spacious, open plan living area with additional seating that can double as a coffee table. Optional French doors and provision for a wall mounted flat screen TV make the Pisces an elegant modern home in which to spend your holiday.

The stylish kitchen has an integrated fridge freezer and built-in microwave, soft close cupboard doors and 600mm wide oven/grill.

There is quality throughout this home from its warm colours and sumptuous soft furnishings to the main bedroom with walk-in wardrobe, dressing table and en suite toilet.



Model illustrated is the 39 x 12 – 2 bedroom with optional front French doors



INTEGRATED OVEN/GRILL
AND FOUR RING HOB
WITH WOK BURNER AND
ELECTRONIC IGNITION



LARGE CAPACITY
INTEGRATED FRIDGE
FREEZER AND STAINLESS
STEEL MICROWAVE



MAIN BEDROOM
FEATURES WALK-IN
WARDROBE, DRESSING
TABLE WITH STOOL AND
EN SUITE TOILET



COMPLETE WITH
LUXURY BED COVERS,
PILLOWCASES AND
BOLSTERS



FOR FULL DETAILS OF
EXTERNAL DIMENSIONS
FOR THIS RANGE
SEE PAGES 26/27

EXTERIOR

- Plastisol coated steel pantile pitched roof
- Lagged hot and cold water exterior pipework
- Under floor insulation
- Exterior Light
- Domestic PVC guttering and down pipes
- Double glazed PVCu exterior door and windows
- Extra warm package - thicker walls and extra insulation
- Pre-galvanised chassis

INTERIOR

- Vaulted ceilings throughout with ceiling cornice in all rooms
- Flush woodgrain effect internal doors with satin steel domestic style door handles
- Energy efficient lighting
- Carbon Monoxide detector, smoke alarm and fire extinguisher
- Underlay fitted beneath all carpets
- Gas combi central heating with thermostatic radiator valves
- Door curtains to exterior door
- Soft close cupboard doors throughout

LOUNGE

- Domestic style, sprung lounge suite with fold-out sprung bed
- Contemporary low-level furniture
- Combination footstool and coffee table (removable seat top)
- Floor lamp with adjustable angle integral reading lamp
- Framed print above fire
- 2Kw glass flame effect electric fire
- Provision for low level TV double sockets and coaxial aerial point
- Provision for flat screen TV above fire (TV and bracket not included)
- Fully lined curtains and voiles/scatter cushions

KITCHEN

- Integrated 600 wide oven and grill
- Separate 4 ring hob with wok burner and electronic ignition
- Glass and stainless steel extractor above hob, externally vented

- Large capacity full height 'A' rated integrated fridge freezer
- Integrated stainless steel microwave
- Velux® window and blind
- 40mm high pressure bonded laminate work surfaces with deep matching upstands

DINING AREA

- Free standing dining table with upholstered chairs
- Fully lined curtains and voiles

MAIN BEDROOM

- 5' x 6'3" double bed with lift up, gas strut assist base, for extra storage
- Duvet covers, pillowcases, bolsters and bed runner
- Fully lined curtains on stainless steel curtainpoles and voiles
- Walk in wardrobe with auto sensing wardrobe light (2 bedroom model)
- Dressing table with upholstered stool
- En suite toilet
- TV point via TV signal booster (TV and bracket not included)

BATHROOM AND ENSUITE WC

- Close coupled toilets
- Soft close toilet seat
- Wall mounted extractor fan
- Venetian blinds
- Shower and thermostatic mixer (Bathroom)
- Large vanity unit with top mounted basin to shower room (Bathroom)
- Large corner basin and pedestal with mirror and shelf above (Ensuite WC)

GUEST BEDROOM

- Freestanding 2'3" x 6'3" metal bed frames with interior sprung mattresses
- Twin beds combine to make a double bed if required
- Duvet covers and pillowcases
- Fully lined curtains on stainless steel curtain poles and voiles
- TV point via TV signal booster (TV and bracket not included)

TV, DVD player, and all other ornaments are for display only.

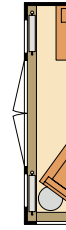

Front door option

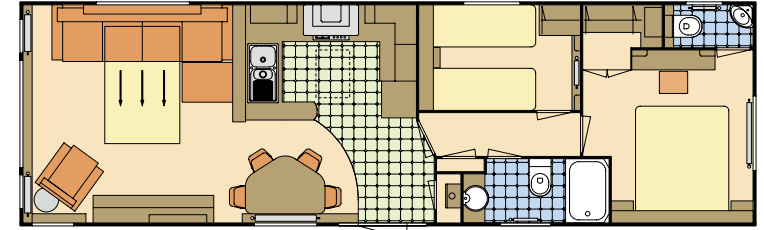

39 x 12 - 2 bedroom 6 berth

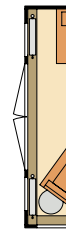

Front door option

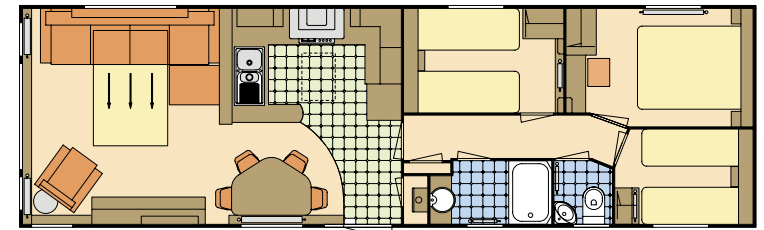

39 x 12 - 3 bedroom 8 berth

OPTIONS

- Double glazed PVCu Front French Doors, including 2 downlighters in front canopy
- Option of up to two appliances, washer/dryer/dishwasher
- Environmental colours
- Canoxel exterior cladding
- Rigid PVC exterior cladding
- Timber cladding (will require routine maintenance)

